

LEPRECHAUN



LEPRECHAUN
CLASS C MOTORHOMES



Step Above.

LEPRECHAUN *Exterior Features*



Slide room awnings (where applicable) to protect your slide room from debris.



Lightweight aluminum framed, vacu-bond laminated crowned roof construction with TPO roof surface. AMOCO Even Cool A/C ducting system with moisture barrier, mold inhibitor, and radius corners for maximum cooling efficiency.

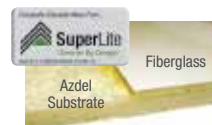

2" thick, aluminum framed sidewall construction with hi-gloss fiberglass exterior & Azdel SuperLite™ sidewall substrate – lightweight, durable & moisture resistant.

Molded fiberglass front WRAP with LED lights (Standard) OR Molded Fiberglass front CAP with LED lights (optional), adding an automotive touch.



Wide running boards.



Warehouse exterior storage – made of anti-corrosive polymer plastic, the seamless and durable exterior storage compartments are built to last.



Optional Exterior Camp Table with sink & refrigerator (319MB only, shown)

Optional Exterior Camp Table Only (210RS, 240FS, 260RS, 260DS, & 280BH)



Standard ONAN 4.0kw gas generator with auto transfer switch and detachable shoreline power cord.



Optional Exterior Entertainment Center with 32" LCD TV/Stereo/DVD & Speakers.



Integrated entry step with easy access auxiliary battery compartment. Solar Panel connection port (Solar panel sold separately)



Leprechaun's one-touch power awning features adjustable arms for ease of use.



At Coachmen, we pride ourselves in providing you with an RV that offers the most feature content on the market, allowing you to fully immerse yourself into any adventure!

- LED lighting throughout
- Congoleum® Designer Carefree vinyl flooring
- Deep bowl sinks with upgraded faucet
- High quality furniture and fabrics
- Large 57" x 95" overhead bunk with ladder (optional child safety net, curtain with Premier Package only)
- Large living room TV with DVD player (Standard on Premier coaches, Optional on Value Leader coaches)
- Large In-dash back-up monitor (Standard on Premier coaches, Optional on Value Leader coaches)
- 3 burner rangetop with oven (Recessed rangetop on Premier coaches only)
- Optional Wash/Dryer combo (311FS only)
- Large Stainless steel residential electric refrigerator with 1,000 watt inverter (311FS only)
- Optional 4-door 12 cu. ft. gas/electric refrigerator (260DS, 280BH only)
- Large galley pantry
- 1-piece Thermofoil dinette table & countertops (optional solid surface kitchen countertop)
- Optional dual recliners (240FS, 260DS, 280BH, 319MB, 311FS) (Premier Package only)



LEPRECHAUN PREMIER *Standards & Options*

STANDARD

WARRANTY

Motorhome – 12 Month/
12,000 Mile Limited Warranty
Chassis Warranty – See Chassis
Owners Manual

PREMIER PACKAGE

Azdel Composite Sidewall Construction
High-Gloss, Color Infused Fiberglass Sidewalls
Molded Fiberglass Front Wrap
with LED Accent Lights
Tinted Windows
Stainless Steel Wheel Inserts
Metal Running Boards
Solar Panel Connection Port
Power Patio Awning
LED Patio Light Strip
LED Exterior Tail & Running Lights
7,500 lb. Towing Hitch with 7-way Plug (Ford E450)
5,000 lb. Towing Hitch with 7-way Plug (Chevy 4500)
LED Interior Lighting
AM/FM/CD Touch Screen Dash Radio with
Bluetooth & Back-up Monitor
Recessed 3 Burner Cooktop with Glass Cover
& Oven
1-Piece Thermofoil Countertops Throughout
Roller Bearing Drawer Glides
Upgraded Vinyl Flooring Throughout
Raised Panel, Hardwood Cabinet Doors
(Flat Panel Lower Doors)
Single Child Tether at Forward Facing Dinette
(N/A 311FS)
Glass Shower Door
Even-Cool A/C Ducting System
80" Long Residential Queen Bed
Night Shades
Bed Area 110V Recept with CPAP Ready
& 12V, USB Charging Station
50 Gallon Fresh Water Tank (ex. 280BH - 46 Gal.)
Water Works Panel with Black Tank Flush
Jack Wing TV Antenna
Onan 4.0KW Generator
Roto-Cast Exterior Warehouse Storage Compartment
Rear Trunk Light
39" TV with Power Lift, Stereo, Speakers,
Subwoofer, HDMI Port (319MB)
Slideout Entertainment Center with 32" TV,
Stereo, Speakers, Fireplace (240FS)
39" TV & DVD Player (311FS)
32" TV & DVD Player (260DS, 280BH)
Bedroom TV Pre-Wire
Air Assist Rear Suspension
Pop-Up Power Tower with 110V-GFI & USB Inputs
Exterior Shower
Upgraded Faucets & Shower Head
Travel Easy Roadside Assistance

EXTERIOR/CONSTRUCTION/CHASSIS

Deluxe Chassis Package
Driver & Passenger Air Bags
Cruise Control
Reclining Driver & Passenger Seats
Tilt Steering Wheel
Dash Air Conditioning
Wood Grain Dash Applique
Power Windows & Locks
Upgraded Exterior Mirrors
Backup Camera
Vacu-Bond Laminated Aluminum Framed Floor
with Dual-Layer Floor Decking Design
Vacu-Bond Laminated 2" Aluminum
Framed Sidewalls
Vacu-Bond Laminated Crowned Aluminum
Framed Roof with TPO Surface
Aluminum Framed Cab-Over & Bunk Floor
Galvanized Steel Entry Step Well with Auxiliary
Battery Storage
Deadbolt Lock at Coach Entrance Door
Exterior Safety Grab Handle
Rear Steel Tube Bumper
Rear Roof Ladder

INTERIOR

Hi-gloss Cappuccino Cherry Wood Grain Cabinets
Decorative Glass Cabinet Door Inserts
in Select Areas
Satin Nickel Cabinet Hardware
Barrel Chair (240FS)
Booth Dinette (280BH)
Dream Dinette Mechanism (280BH)
J-Dinette with Pullout Auxiliary Seat (260DS)
U-Dinette (240FS, 311FS, 319MB)
Upgraded Silver Pedestal Table Leg (N/A 280BH)
Jackknife Sofa (N/A 240FS)
Interior Safety Grab Handle at Entrance Door
LP Leak Alarm
Smoke Detector
Carbon Monoxide Detector
Fire Extinguisher

GALLEY

Microwave Oven
Power Range Hood
Double Door Refrigerator (N/A 311FS)
Stainless Steel Residential Refrigerator with
1,000 Watt Inverter (311FS)
Upgraded Under-Mount Kitchen Sink with Cover
Satin Nickel Kitchen Faucet with Sprayer Head
Kitchen Flip Up Extension
(240FS, 260RS, 260DS)
Upgraded Stone Kitchen Backsplash

BATHROOM

Power Bath Vent Fan
Top Mount Lavatory Sink
Single Lever Lavatory Faucet
Lavatory Mirror
Towel Ring, TP Holder & Robe Hooks
ABS Molded Shower Pan & Surround
Porcelain Foot Flush Toilet
Skylight Over Shower

SLEEPING

Queen Bed - 60" x 80"
Upgrade Bedspread
Upgrade Headboard
Cab-Over Bunk - 57" x 95"
Cab-Over Privacy Curtain
Cab-Over Bunk Ladder
Child Safety Net - Cab-Over
Interior Privacy Drape for Chassis Cab
Jackknife Sofa Auxiliary Bed (N/A 240FS)
Booth Dinette Auxiliary Bed (280BH)
J-Dinette Auxiliary Bed (260DS)
U-Dinette Auxiliary Bed (240FS, 311FS, 319MB)

ELECTRICAL/HEATING/AC/PLUMBING

30 AMP Power Cord
55 AMP Electronic Converter
Auxiliary Battery
Auxiliary Battery Disconnect
Auto Generator Changeover
GFI Circuit
Wall Mounted Digital Thermostat
30,000 BTU Ducted Furnace
(240FS, 260DS, 280BH, 319MB)
2 - 18,000 BTU Ducted Furnaces (311FS)
13,500 BTU Ducted Roof A/C
Exterior Recept & Coax Connection
Coach Command Center
Exterior TV Ready Compartment
Exterior Safety Grab Handle
Bed Area 110V, CPAP Ready Area
with 12V & USB Charging Station
Detachable Shoreline Power Cord
6-Gallon Gas E.I. Water Heater
Low Point Drain & Easy Winterize Valve
PEX Fresh Water Lines
HEPVO Drain Valves
Demand Water Pump
Upgraded Waste Tank Termination Center

PARTIAL BODY PAINT



OPTIONAL

STAND ALONE OPTIONS

24" LCD & DVD Player in Bedroom
(260RS, 260DS, 280BH, 319MB)
19" LCD & DVD Player in Bedroom (311FS)
Exterior Entertainment Center with 32" TV/DVD/
Stereo/Speakers/HDMI Port (319MB)
Exterior Entertainment Center
with 24" TV/DVD/ Stereo/Speakers/HDMI Port
(240FS, 260DS, 280BH, 311FS)
Side View Cameras
Tailgater Satellite Dome & Receiver
Exterior Camp Kitchen Table
with Refrigerator & Sink (319MB)
Exterior Camp Kitchen Table
(240FS, 260DS, 280BH)
Dual Recliners
Power Salon Bunk (280BH)
Driver Swivel Seat
Passenger Swivel Seat
Exterior Windshield Cover
Cockpit Folding Table (Ford Chassis Only)
15,000 BTU Low Profile A/C with Heat Pump
Solid Surface Kitchen Countertop
with Under-Mount Stainless Steel Sink
Electric Fireplace (319MB, Standard on 240FS)
Side-by-Side Refrigerator (260DS, 280BH)
Washer/Dryer Combo (311FS)
Camping Cozy Package -
Dual Pane Windows, Heated Tank Pads,
Tank Gate Valves
Heated Tank Pads (Only)
Spare Tire
Aluminum Rims
Electric Equalizer Stabilizer Jacks
(Mandatory on 311FS)
Hydraulic Leveling Jacks
Fiberglass Front Cap with LED Strip Lights
Painted Cab - Carmel
Partial Body Paint
Full Body Paint - Ruby or Onyx with Front Cap
Z240 CSA - RV Compliance (Ford Only)
Canadian Compliance - Chassis (Speedo &
Daytime Running Lights) (Ford Only)
CD-MVSA (Mandatory, Ford Only)

FULL BODY PAINT OPTIONS



Ruby

COMFORT AND CONVENIENCE PACKAGE

In-Dash Navigation with Touch Screen Radio
Controls & Backup Monitor
Convection Microwave
Upgrade Queen Bed Mattress
6-Gallon Gas/ Electric E.I. Water Heater
Heated, Remote Exterior Mirrors
Upgraded Fiberglass Running Boards
2-Tone Leatherette Cockpit Seats
Cab-Over & Bedroom Power Vent Fans
with MaxxAir Covers
Dual Aux Batteries
Slideout Awning(s)

DÉCOR OPTIONS

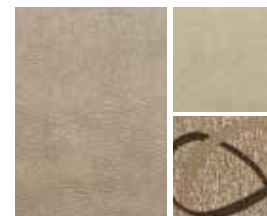

CHOCOLATE

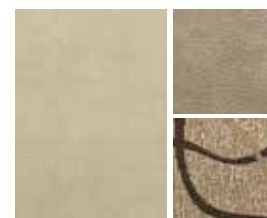

VANILLA

*Due to continuous improvement,
Standards and Options subject
to change without notice.*



Onyx

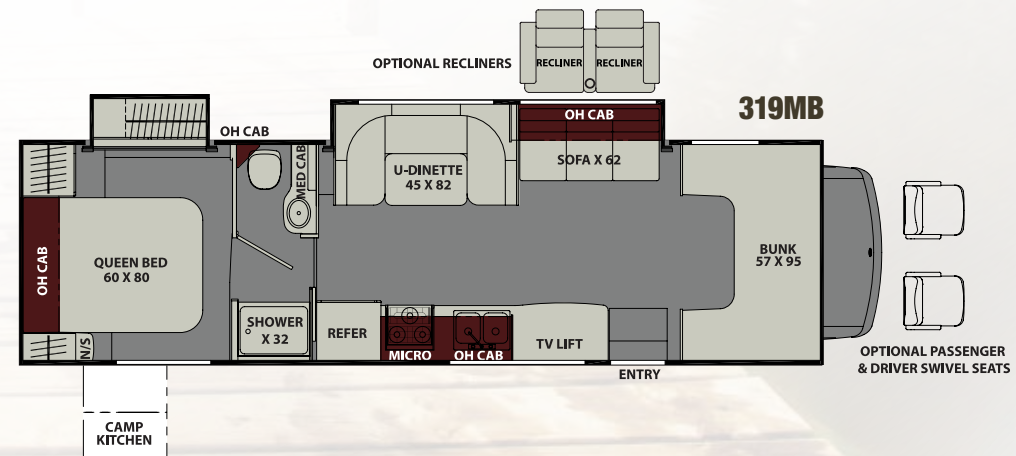
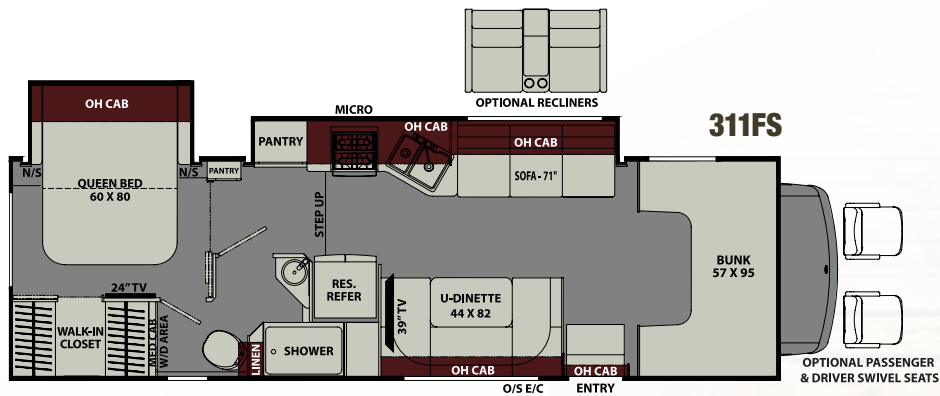
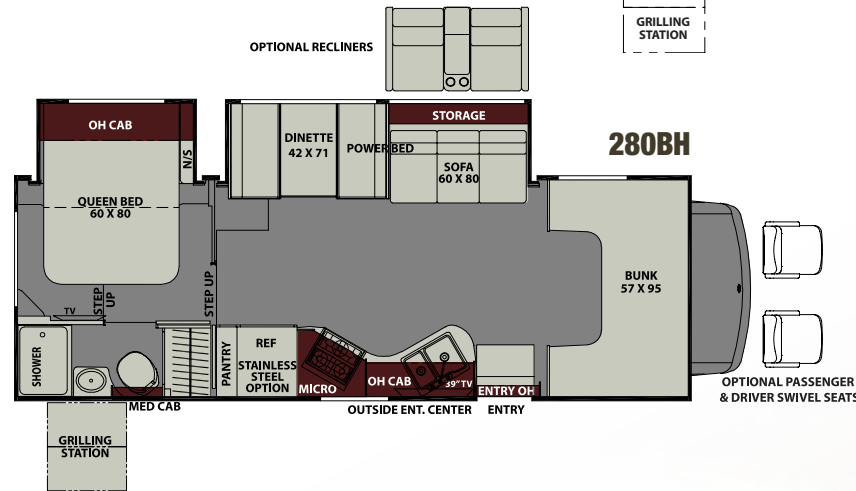
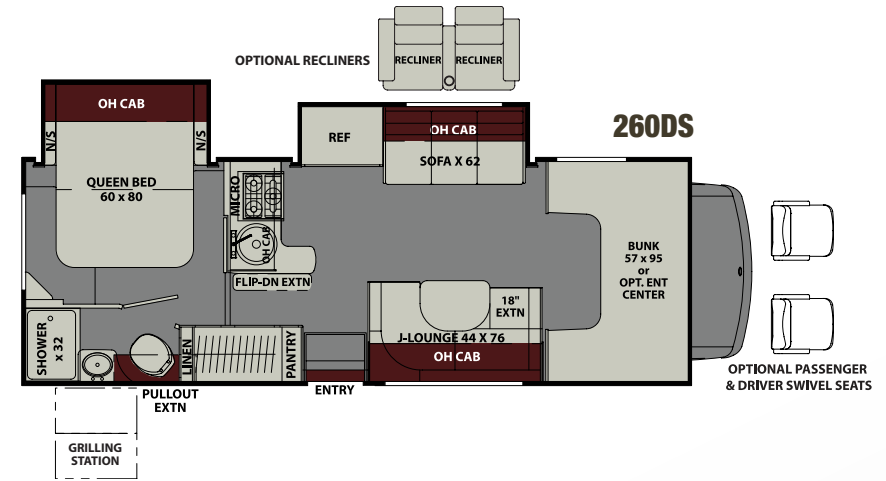
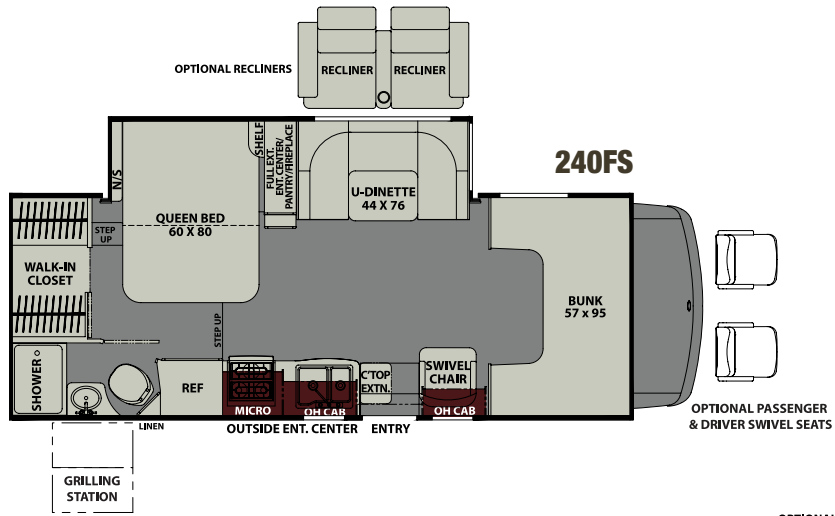

LEPRECHAUN VALUE LEADER *Standards & Options*

STANDARD

WARRANTY

Motorhome – 12 Month/
12,000 Mile Limited Warranty
Chassis Warranty – See Chassis
Owners Manual

VALUE LEADER PACKAGE

Azdel Composite Sidewall Construction
High-Gloss, Color Infused Fiberglass Sidewalls
Molded Fiberglass Front Wrap
with LED Accent Lights
Tinted Windows
Stainless Steel Wheel Inserts
Metal Running Boards
Solar Panel Connection Port
Power Patio Awning
LED Patio Light Strip
LED Exterior Tail & Running Lights
5,000lb. Towing Hitch with 7-way Plug
LED Interior Lighting
AM/FM/CD Touch Screen Dash Radio
with Bluetooth
3 Burner Cooktop & Oven
1-Piece Thermofoil Countertops Throughout
Roller Bearing Drawer Glides
Upgraded Vinyl Flooring Throughout
Raised Panel, Hardwood Cabinet Doors
(Flat Panel Lower Doors)
Single Child Tether at Forward Facing Dinette
(N/A 210QB)
Glass Shower Door
Even-Cool A/C Ducting System (N/A 210QB)
80" Long Residential Queen Bed
Night Shades
Bed Area 110V Recept with CPAP Ready
& 12V, USB Charging Station
50 Gallon Fresh Water Tank (ex. 270QB - 40 Gal.)
Water Works Panel with Black Tank Flush
Jack Wing TV Antenna
Onan 4.0KW Generator
Roto-Cast Exterior Warehouse
Storage Compartment
Travel Easy Roadside Assistance

EXTERIOR/CONSTRUCTION/CHASSIS

Deluxe Chassis Package
Driver & Passenger Air Bags
Cruise Control
Reclining Driver & Passenger Seats
Tilt Steering Wheel
Dash Air Conditioning
Power Windows & Locks
Upgraded Exterior Mirrors
Vacu-Bond Laminated Aluminum Framed Floor
with Dual-Layer Floor Decking Design
Vacu-Bond Laminated 2" Aluminum
Framed Sidewalls
Vacu-Bond Laminated Crowned Aluminum
Framed Roof with TPO Surface
Aluminum Framed Cab-Over & Bunk Floor
Galvanized Steel Entry Step Well
with Auxiliary Battery Storage
Deadbolt Lock at Coach Entrance Door
Rear Steel Tube Bumper
Rear Roof Ladder

INTERIOR

Hi-gloss Cappuccino Cherry Wood Grain Cabinets
Decorative Glass Cabinet Door Inserts
in Select Areas
Satin Nickel Cabinet Hardware
Booth Dinette (270QB)
U-Dinette (210QB)
Sure Fit Dinette Table Pedestal Legs
(210QB, 270QB)
J-Dinette with Pullout Auxiliary Seat
(210RS, 260RS)
Upgraded Silver Pedestal Table Leg
(210RS, 260RS)
Jackknife Sofa (260RS, 270QB)
Interior Safety Grab Handle at Entrance Door
LP Leak Alarm
Smoke Detector
Carbon Monoxide Detector
Fire Extinguisher

GALLEY

Microwave Oven
Power Range Hood
Double Door Refrigerator
Top-Mount Kitchen Sink
Satin Nickel Kitchen Faucet
Kitchen Flip Up Extension (210QB, 270QB)
Upgraded Kitchen Backsplash

BATHROOM

Power Bath Vent Fan
Demand Water Pump
Top Mount Lavatory Sink
Single Lever Lavatory Faucet
Lavatory Mirror
Towel Ring, TP Holder & Robe Hooks
ABS Molded Shower Pan & Surround
Foot Flush Toilet
Skylight Over Shower

SLEEPING

Queen Bed - 60" x 80"
Bedsread
Cab-Over Bunk - 57" x 95"
Cab-Over Ladder
Interior Privacy Drape for Chassis Cab
Jackknife Sofa Auxiliary Bed (260RS, 270QB)
Booth Dinette Auxiliary Bed (270QB)
J-Dinette Auxiliary Bed (210RS, 260RS)
U-Dinette Auxiliary Bed (210QB)

ELECTRICAL/HEATING/AC/PLUMBING

30 AMP Power Cord
55 AMP Electronic Converter
Auxiliary Battery
Auxiliary Battery Disconnect
Auto Generator Changeover
GFI Circuit
Wall Mounted Digital Thermostat
30,000 BTU Ducted Furnace (260RS, 270QB)
20,000 BTU Ducted Furnace (210QB, 210RS)
13,500 BTU Non-Ducted Roof A/C (210QB)
13,500 BTU Ducted Roof A/C
(210RS, 260RS, 270QB)
Exterior Recept & Coax Connection
Coach Command Center
Exterior TV Ready Compartment
Exterior Safety Grab Handle
Bed Area 110V, CPAP Ready Area
with 12V & USB Charging Station
Detachable Shoreline Power Cord
6-Gallon Gas E.I. Water Heater
Low Point Drain & Easy Winterize Valve
PEX Fresh Water Lines
HEPVO Drain Valves
Demand Water Pump

OPTIONAL

STAND ALONE OPTIONS

32" Coach TV & DVD
AM/FM/CD Touch Screen Dash Radio
with Bluetooth & Back-up Monitor
Exterior Entertainment Center
with 24" TV/DVD/ Stereo/Speakers/HDMI Port
Exterior Camp Kitchen Table (210RS, 260RS)
Child Safety Net - Cab-Over
Driver Swivel Seat (210RS)
Passenger Swivel Seat (210QB, 210RS, 260RS)
Cockpit Folding Table (Ford Chassis Only)
Upgraded Queen Bed Mattress (Where Applicable)
Slide Out Awning
15,000 BTU Low Profile A/C with Heat Pump
(210RS, 260RS, 270QB)
Cab-Over & Bedroom Power Vent Fan
with MaxxAir Covers
Spare Tire
Electric Equilizer Stabilizer Jacks
Z240 CSA - RV Compliance (Ford Only)
Canadian Compliance - Chassis (Speedo &
Daytime Running Lights) (Ford Only)
CD-MVSA (Mandatory, Ford Only)

DÉCOR OPTIONS

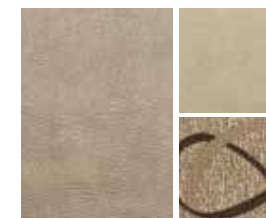

CHOCOLATE

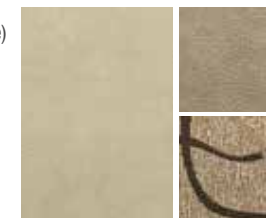

VANILLA

*Due to continuous improvement,
Standards and Options subject
to change without notice.*



Coachmen Owner "Digital Kit" App

Now you can have your Owner's Manual with you wherever you are. Download our FREE App from the App Store or Google Play and you'll have the information right at your fingertips.

210QB

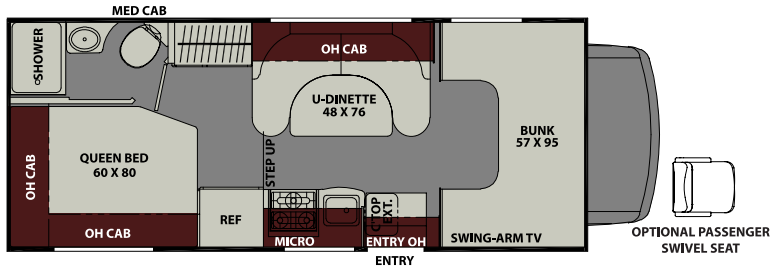

210RS

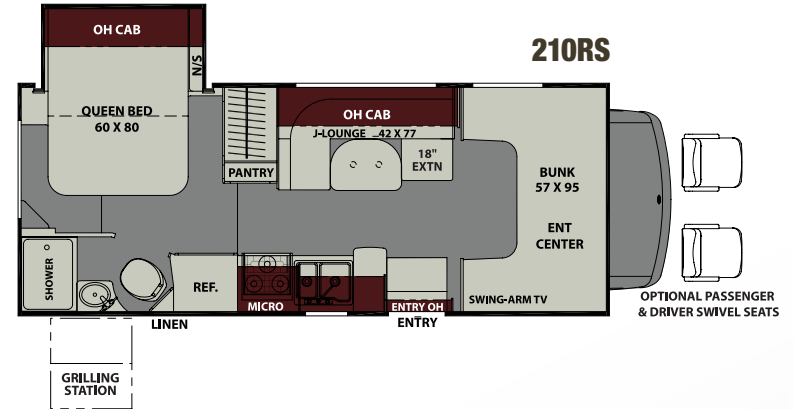

260RS

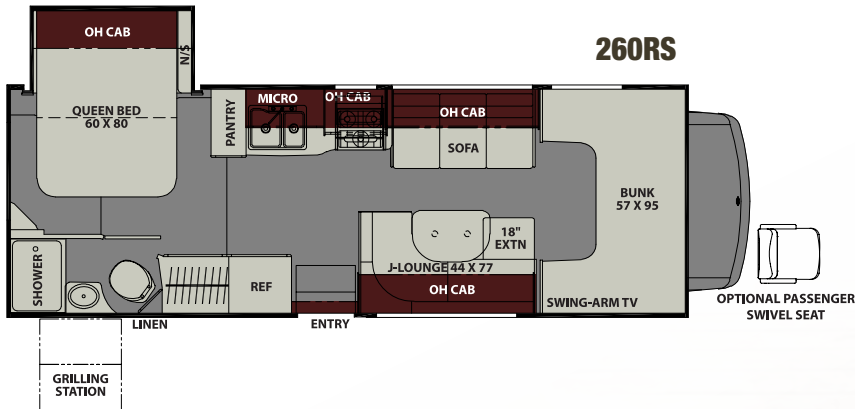

270QB

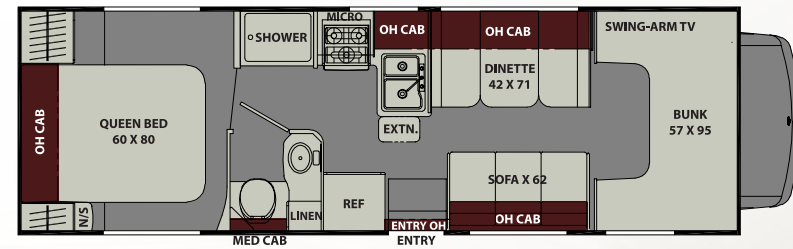

LEPRECHAUN *Specifications*

MODEL	240FS	260DS	280BH	311FS	319MB	210QB	210RS	260RS	270QB
Chassis	4500-CHEVY / 450 FORD	4500-CHEVY / 450 FORD	450 FORD	450 FORD	450 FORD	4500-CHEVY / E350 FORD	4500-CHEVY / E350 FORD	4500-CHEVY / E350 FORD	4500-CHEVY / E350 FORD
Engine	V8-6.0L / V10-6.8L	V8-6.0L / V10-6.8L	V8-6.0L / V10-6.8L	V10-6.8L	V10-6.8L	V8-6.0L / V10-6.8L	V8-6.0L / V10-6.8L	V8-6.0L / V10-6.8L	V8-6.0L / V10-6.8L
Horse Power	324 / 305	324 / 305	324 / 305	305	305	324 / 305	324 / 305	324 / 305	324 / 305
Torque	373 / 420	373 / 420	373 / 420	420	420	373 / 420	373 / 420	373 / 420	373 / 420
Wheel Base	183" / 182"	191" / 190"	198"	220"	223"	159" / 158"	159" / 158"	191" / 190"	191" / 190"
GVWR (lbs.)	14,200 / 14,500	14,200 / 14,500	14,500	14,500	14,500	14,200 / 12,500	14,200 / 12,500	14,200 / 12,500	14,200 / 12,500
GCWR (lbs.)	20,000 / 22,000	20,000 / 22,000	22,000	22,000	22,000	20,000 / 18,500	20,000 / 18,500	20,000 / 18,500	20,000 / 18,500
UVW (approx. lbs.)	11,234 / 11,322	11,820 / 11,874	TBD	12,867	12,671	9,583 / TBD	10,376 / 10,175	10,792 / TBD	TBD
CCC (approx. lbs.)	2,966 / 3,178	2,380 / 2,262	TBD	1,633	1,829	4,617 / TBD	3,824 / 2,257	3,471 / TBD	TBD
GAWR Front (lbs.)	4,600 / 5,000	4,600 / 5,000	5,000	5,000	5,000	4,600 / 5,000	4,600 / 5,000	4,600 / 5,000	4,600 / 5,000
GAWR Rear (lbs.)	9,600 / 9,600	9,600 / 9,600	9,600	9,600	9,600	9,600 / 8,500	9,600 / 8,500	9,600 / 8,500	9,600 / 8,500
Interior Height	6' 11"	6' 11"	6' 11"	6' 11"	6' 11"	6' 11"	6' 11"	6' 11"	6' 11"
Exterior Width	8' 4"	8' 4"	8' 4"	8' 4"	8' 4"	8' 4"	8' 4"	8' 4"	8' 4"
Exterior Height (with A/C)	10' 11"	10' 11"	10' 11"	10' 11"	10' 11"	10' 10"	10' 11"	10' 11"	10' 11"
Exterior Length (with Hitch)	26' 9" / 26' 3"	27' 11" / 27' 5"	28' 5"	31' 10"	32' 11"	24' 6" / 24' 0"	24' 9" / 24' 3"	27' 11" / 27' 5"	30' 0" / 29' 6"
Hitch Weight (lbs.)	5,000 / 7,500	5,000 / 7,500	7,500	7,500	7,500	5,000	5,000	5,000	5,000
Fuel Capacity (gal.)	57 / 55	57 / 55	55	55	55	57 / 55	57 / 55	57 / 55	57 / 55
LP Capacity (lbs.)	68	68	68	68	68	68	68	68	40
Fresh Water Capacity (gal.)	50	50	43	50	50	50	50	50	40
Water Heater Capacity (gal.)	6	6	6	6	6	6	6	6	6
Grey Tank Capacity (gal.)	28	31	31	32	32	28	28	31	31
Black Tank Capacity (gal.)	31	31	31	31	29	22	31	31	31
Exterior Storage (cu. ft.)	55	60	83	70	100	92	67	60	77
Awning Length	17'	18'	19'	19'	21'	15'	15'	18'	20'

GVWR (Gross Vehicle Weight Rating) is the maximum permissible weight of the unit when fully loaded. It includes all weights, inclusive of all fluids, occupants, cargo, optional equipment and accessories. For safety and product performance do NOT exceed the GVWR.

GCWR (Gross Combined Weight Rating) is the maximum permissible loaded weight of your motor home and any towed trailer or towed vehicle. Actual GCWR of this vehicle may be limited by the sum of the GVWR and the installed hitch receiver maximum capacity rating; see hitch rating label for detail.

GAWR (Gross Axle Weight Rating) is the maximum permissible weight, including cargo, fluids, optional equipment and accessories that can be safely supported by each axle.

UVW (Unloaded Vehicle Weight) * is the typical weight of the unit as manufactured at the factory. It includes all weight at the unit's axle(s), including full fuel, all fluids and LP Gas. The UVW does not include cargo, fresh potable water, additional optional equipment or dealer installed accessories.

*Estimated Average based on standard build optional equipment.

CCC (Cargo Carrying Capacity) ** is the amount of weight available for fresh potable water, cargo, passengers, additional optional equipment and accessories. CCC is equal to GVWR minus UVW. Available CCC should accommodate fresh potable water (8.3 lbs per gallon). Before filling the fresh water tank, empty the black and gray tanks to provide for more cargo capacity.

** Estimated average based on standard build optional equipment

Each Coachmen motorhome is weighed at the manufacturing facility prior to shipping. A label identifying the unloaded vehicle weight of the actual unit and the cargo carrying capacity is applied to every Coachmen motorhome prior to leaving our facilities.

The load capacity of your unit is designated by weight, not by volume, so you cannot necessarily use all available space when loading your unit.

Actual towing capacity is dependent upon your particular loading and towing circumstances, which includes the GVWR, GAWR and GCWR as well as adequate trailer brakes. Please refer to the Operator's Manual of your vehicle for further towing information.



Travel Easy™ Roadside Assistance

RVing is easier with Coachmen's Travel Easy™ Roadside Assistance provided FREE the first year of ownership to those who purchase a New Coachmen RV. Administered by Coach-Net, this service provides you with 24/7 operational, technical and emergency road service coverage. Also included is towing, fuel delivery, jump starts, lockout service, tire changes, mobile mechanic and unlimited technical assistance. Anywhere. Anytime. Travel Easy™ is the security of knowing that help is an easy phone call away.

Your LEPRECHAUN Dealer

CUSTOMER SATISFACTION



www.ForestRiverBuyLocal.com



FREE MEMBERSHIP
www.coachmenowners.com



Learn More
Scan this barcode using a QR Reader on your smart phone to learn more about Forest River.



A Berkshire Hathaway company.

All information contained in this brochure is believed to be accurate at the time of publication. However, during the model year, it may be necessary to make revisions and Coachmen reserves the right to make all such changes without notice, including prices, colors, materials, equipment and specifications as well as the addition of new models and the discontinuance of models shown in this brochure. Therefore, please consult with your Coachmen dealer and confirm the existence of any materials, design or specifications that are material to your purchase decision. 1/18

©Copyright 2018 Coachmen RV a Division of Forest River Inc – All Rights Reserved.



Coachmen
Leader to the Great Outdoors.

423 N. Main Street • P.O. Box 30
Middlebury, IN 46540

To learn more about Coachmen RV and our products and see how Coachmen is making the easy life easier, call us toll free at (800) 353-7383, or visit www.coachmenrv.com