

# Sightseer

**WINNEBAGO**<sup>TM</sup>



## *Why Sightseer?*

- Three innovative floorplans
- Available powered StudioLoft™ drop-down bed
- Ultraleather™ swivel cab seats
- MCD solar/blackout roller shades
- Choice of queen or king bed
- Corian® countertops with decorative backsplash
- Leveling jacks with 3-position controls
- Powered patio awning with LED lighting and metal wrap
- Electric fireplace (35G, 36Z)
- Full-body paint with high-luster clear coat finish



On the Cover: 35G Scarlet Full-Body Paint

35G Mountain View with Coffee-Glazed Vienna Maple Cabinetry

## Take the Scenic Route

The Sightseer® invites you to open your eyes to great value and good times in Class A comfort. Three floorplans deliver your perfect living experience built to Winnebago's® exacting standards. LED ceiling lights bring energy efficiency to a coach already loaded with premium features such as Corian® countertops, MCD solar/blackout roller shades, and

Ultraleather™ cab seats. The 35G delivers exceptional travel flexibility with the inLounge™ extendable sectional sofa and movable inTable™. For additional sleeping space, add the StudioLoft™ drop-down cab bed to any floorplan. Make time to take the scenic route in the family-friendly Sightseer.



**Recognized Quality** The Recreation Vehicle Dealer Association annually rates RV manufacturers and awards the Quality Circle Award to manufacturers that provide exceptional products, service, and support. Winnebago is proud to be the only manufacturer that has received this award every year since its inception.



## Best in Class

See how Winnebago takes motorhome design and function to the next level, and why we've earned the right to be called the Most Recognized Name in Motorhomes.®



Click on this icon throughout the brochure to link to more information on the web.



The **Dash Workstation** is the perfect place to plan your trip.



The **inLounge™** becomes exactly what you need it to be; a sofa, dining seating, or an additional space for sleeping.



Kick back and relax in the Ultraleather™ hoop-base **Recliner** with a built-in footrest. It reclines, swivels, and can be moved to your favorite spot when you're not traveling.





With three feature-rich floorplans, it's easy to customize the Sightseer lounge to your preferences. Whether you want an available Rest Easy® sofa (33C, 36Z) or an inLounge™ with a comfortable electric fireplace (35G), there's an arrangement to perfectly suit your style. At the end of a long day, relax in front of an HDTV that is connected to a DVD stereo system.







You'll enjoy preparing meals and snacks in this comfortable galley with popular amenities such as a three-burner range top, a microwave/convection oven, and a large, four-door refrigerator/freezer with an icemaker. The pantry (33C, 36Z) and full-extension drawer slides provide an abundance of storage space, while the Corian® solid-surface countertops and matching sink covers offer plenty of space for food prep. There's even a decorative galley backsplash for added style.







35G inLounge With inTable



35G inTable Storage

The Sightseer offers plenty of dining arrangements. Choose from an elegant, extendable Glide & Dine dining table/buffet and chairs with a retractable HDTV (33C), or the BenchMark® dinette (36Z). For a more relaxed setting, choose the extendable inLounge® with movable inTable™ (35G).





35G Bedroom

Unwind after a long day on your walk-around queen or available king bed, and enjoy the standard HDTV. With a chest of drawers (35G) and spacious wardrobe with additional storage, you'll have plenty of space to store your traveling necessities.



35G Shower



35G Bedroom HDTV



35G Bathroom



35G Wardrobe





Dash

Pilot your Sightseer with confidence thanks to the easy-to-read controls, rearview color monitor system with 6" touchscreen, and the six-way power Ultraleather™ driver seat. Your co-pilot will be pleased with the extra space provided by the dash workstation, and you'll have hours of entertainment on the road with the iPod®/MP3 input and available SiriusXM™ satellite radio (subscription not included). Both cab seats swivel to face the lounge area to enhance your living space while parked.



Powered Mirrors with Defrost



Swivel Cab Seats



MCD Solar/Blackout Powered Front Shade



# Sightseer Exterior

**WINNEBAGO**<sup>®</sup><sub>IND</sub>

Experience greater outdoor enjoyment with the powered patio awning with LED lighting and metal wrap, and the available exterior entertainment center with an HDTV. Your gear is easy to access with the StoreMore<sup>®</sup> slideout storage system (featured on the 33C), while the single-paddle latches on the doors make for easy one-handed operation. A color-coded exterior service center and automatic hydraulic leveling jacks with three-position controls make hookups quick and easy.



35G Powered Patio Awning



Available Exterior Entertainment Center



Exterior Service Center



Powered Patio Awning with LED Lighting



Stylized Aluminum Wheels



## Fiberglass Roof

The crowned, one-piece fiberglass roof is backed by a 10-year limited parts-and-labor roof skin warranty.

## Rubber Can't Cut It

Rubber roofs used by competitors can streak and degrade over time.

## Thermo-Panel® Sidewalls

By layering fiberglass and high-density block foam insulation with welded aluminum support structures, we create some of the industry's strongest, most durable, and lightweight sidewalls.

**Embedded Steel** Metal substructures embedded into the sidewall provide solid attachment points to keep cabinets and appliances mounted securely in place.

**Laser-Cut Tubing** Precision laser cutters create precise joints in structural steel that are stronger and require less welding.

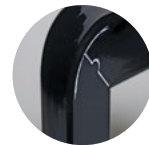

**Interlocking Joints** Specially engineered interlocking joints connect the floor, sidewalls, and roof where competitors often rely on simple screws to bear the weight.



**Solid Framework** Aluminum extruded in our own facility to our exacting standards creates an extremely strong and solid structural framework.

**E-Coating** An electrodeposition coating helps protect critical steel components.

# SUPER STRUCTURE<sup>®</sup>

B U I L T   T O   L A S T

Every coach—from our smallest Class C to our largest diesel-pusher model—is built to Winnebago's® legendary SuperStructure® construction standards. It's a process developed and refined over more than 50 years of building some of the strongest, most durable coaches in the industry.



## TESTING

Before rolling out of our factories, every coach undergoes an extensive 113-point inspection. Each coach also passes a high-pressure water test that simulates rain at a rate of 50-inches per hour to check for leaks. During the design process, our computer simulations, physical testing center, and rigorous test track ensure each model is built to last.



## DETAILS

At Winnebago, we treat the features you can't see with the same care as the ones you can. Look in the access panels of some of our competitors' coaches and you'll see loose insulation and wires haphazardly strewn about. Winnebago maintains a clean fit and finish throughout so your coach will last for the long haul.



## BUILT IN-HOUSE

We extrude our own aluminum. We rotocast our own plastic components. In fact, we manufacture most of our own parts so they are designed to fit the space, rather than fitting the space to an awkward off-the-shelf component size.

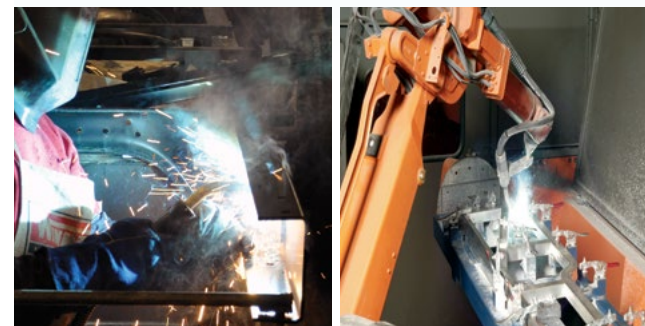

**SUPER  
STRUCTURE**  
BUILT TO LAST



Visit [BetterBuiltRVs.com](http://BetterBuiltRVs.com) to gain real insight into what goes into a Winnebago motorhome.

## TAKE A TOUR

We're proud of our processes, state-of-the-art facilities, and the people who make Winnebago number one. We invite you to visit our complex in Forest City, Iowa, for a firsthand look at the dedication and technology behind every motorhome we build.

Call 641-585-6936 or 1-800-643-4892 or visit us online at [WinnebagoInd.com/company/visit](http://WinnebagoInd.com/company/visit) for more information.



[WinnebagoInd.com](http://WinnebagoInd.com)



## 33C

Popular features abound in this triple-slideout floorplan, including an available Euro recliner, available Rest Easy® sofa, Glide & Dine dining table/buffet with a retractable HDTV, and an available king bed.

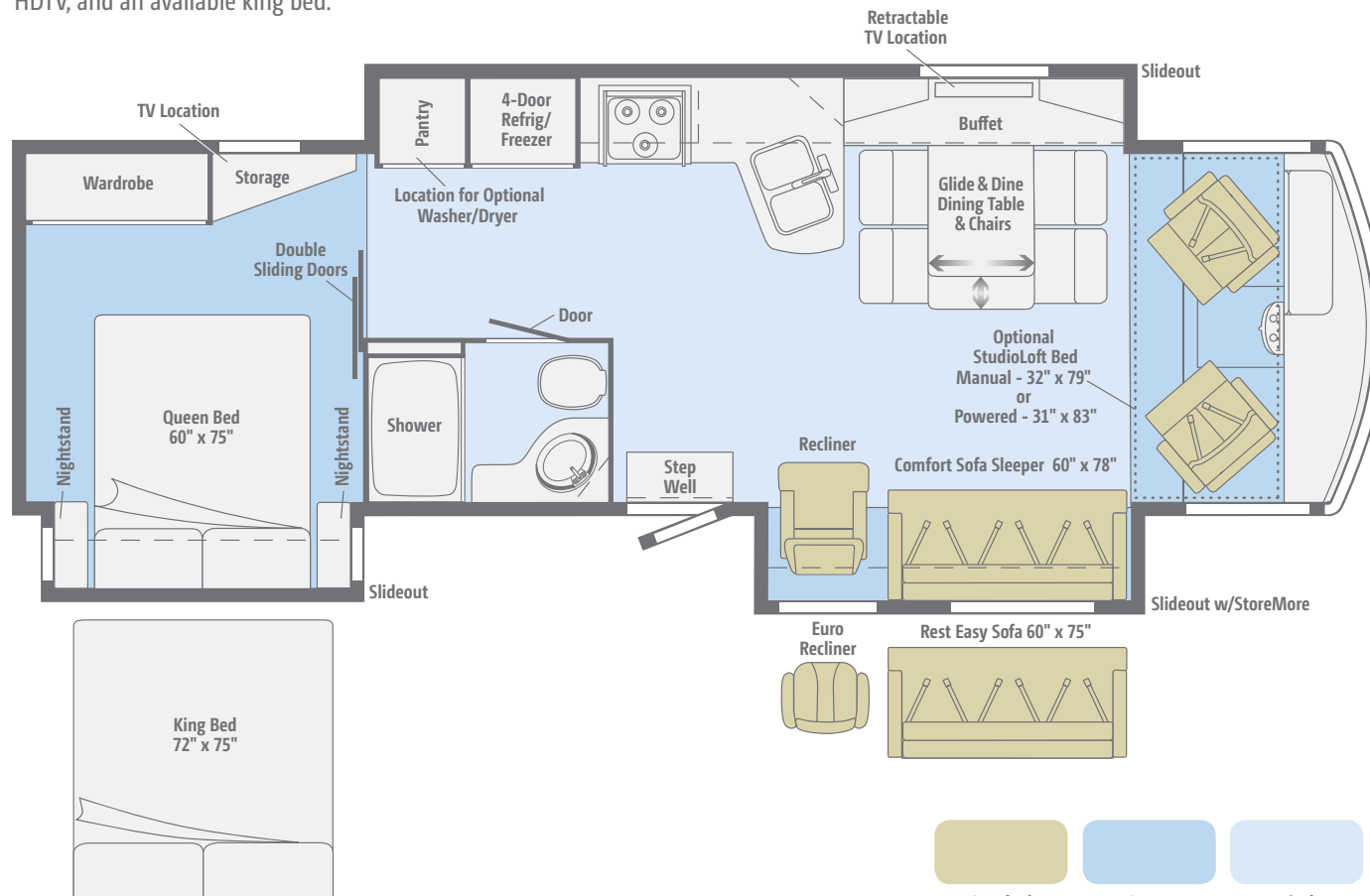

Dimensions shown are for sleeping space only and may vary due to styling differences. Dashed lines denote overhead storage areas. Floorplans and specifications are also available online at [WinnebagoInd.com](http://WinnebagoInd.com).



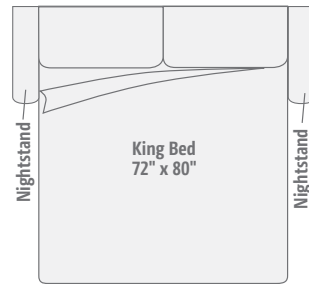

## 35G

Functional amenities in this spacious, triple-slideout floorplan include an inLounge™ extendable sofa/sleeper with movable inTable™, an electric fireplace, mid-coach HDTV, and available king bed.

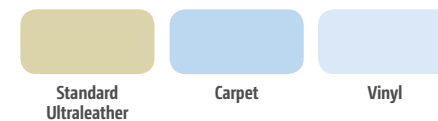
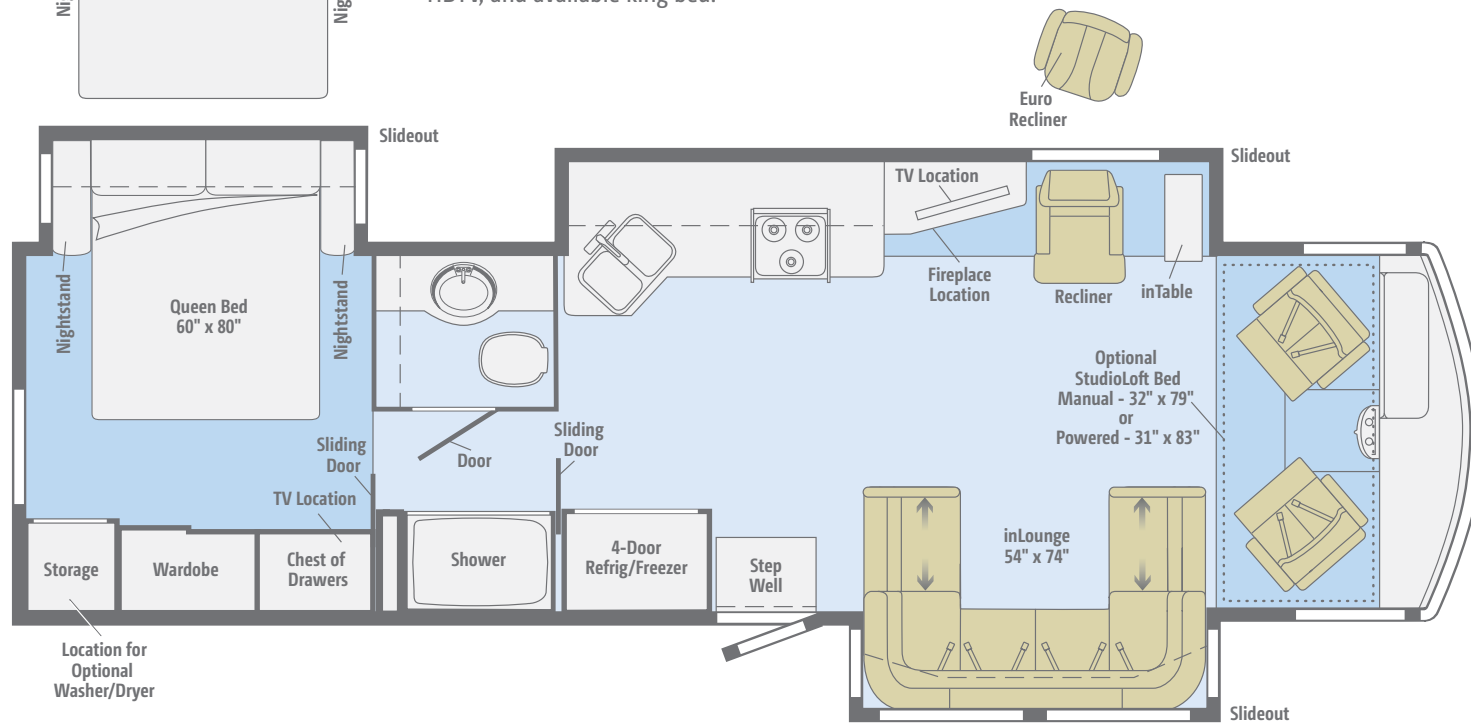

Dimensions shown are for sleeping space only and may vary due to styling differences. Dashed lines denote overhead storage areas. Floorplans and specifications are also available online at [WinnebagoInd.com](http://WinnebagoInd.com).



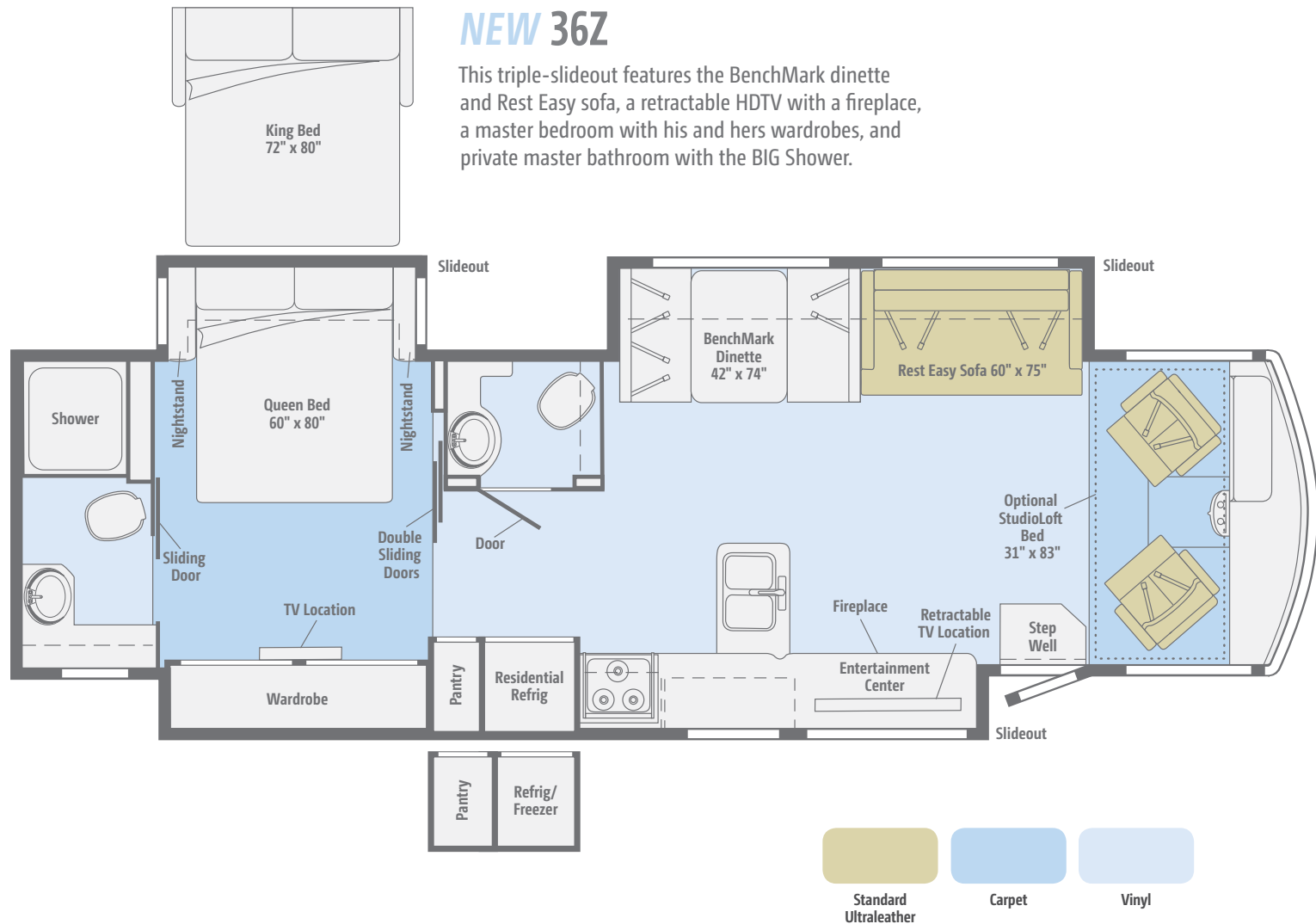

Dimensions shown are for sleeping space only and may vary due to styling differences. Dashed lines denote overhead storage areas. Floorplans and specifications are also available online at [WinnebagoInd.com](http://WinnebagoInd.com).



Choose from three fabric collections and two wood finishes.

## Fracture



Main



Ultraleather



Accent



Bedspread



Corian Countertop  
(Galley)



Wall Board



Carpet

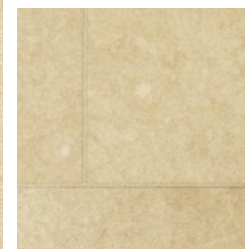

Vinyl



Coffee-Glazed  
Vienna Maple



Coffee-Glazed  
Honey Cherry

*Winnebago reserves the right to change décor materials and specifications without notice or obligation.*

Choose from three fabric collections and two wood finishes.

## Mountain View



Main



Ultraleather



Accent



Bedspread



Corian Countertop  
(Galley)

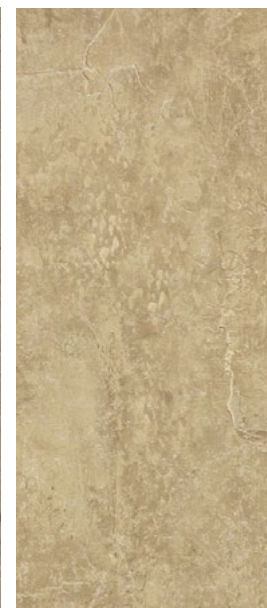

Wall Board



Carpet

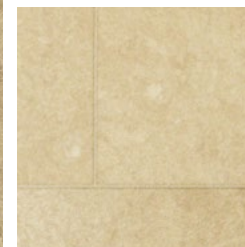

Vinyl



Coffee-Glazed  
Vienna Maple



Coffee-Glazed  
Honey Cherry

*Winnebago reserves the right to change décor materials and specifications without notice or obligation.*



Choose from three fabric collections and two wood finishes.

## Grayson



Main



Ultraleather



Accent



Bedsread



Corian Countertop  
(Galley)



Wall Board



Carpet



Vinyl



Coffee-Glazed  
Vienna Maple



Coffee-Glazed  
Honey Cherry

*Winnebago reserves the right to change décor materials and specifications without notice or obligation.*

# Sightseer Paint

**WINNEBAGO**<sup>IND</sup>

Choose from four stylish full-body paint selections.



**Light Khaki**  
FULL-BODY PAINT



**Mahogany**  
FULL-BODY PAINT



Choose from four stylish full-body paint selections.



**Hot Iron**  
FULL-BODY PAINT



**Scarlet**  
FULL-BODY PAINT

## Weights & Measures

	33C	35G	36Z
Length	34'8"	36'6"	37'6"
Exterior Height <sup>1</sup>	12'5"	12'4"	12'4"
Exterior Width <sup>2</sup>	8'5.5"	8'5.5"	8'5.5"
Exterior Storage <sup>3</sup> (cu. ft.)	104	115.8	122.2
Awning Length - Front/Rear	19'	18'	20'
Interior Height	6'8"	6'8"	6'8"
Interior Width	8'0.5"	8'0.5"	8'0.5"
Freshwater Tank Capacity <sup>4</sup> (gal.)	73	80	83
Water Heater Capacity (gal.)	10	10	10
Holding Tank Capacity - Black/Gray <sup>4</sup> (gal.)	39/60	38/50	33/41 & 47/44*
LP Capacity <sup>5</sup> (gal.)	18	18	18
Fuel Capacity (gal.)	80	80	80
GCWR <sup>6</sup> (lbs.)	26,000	26,000	26,000
GVWR (lbs.)	22,000	22,000	22,000
GAWR - Front (lbs.)	8,000	8,000	8,000
GAWR - Rear (lbs.)	15,000	15,000	15,000
Wheelbase	220"	228"	242"

\*The 36Z uses separate black and gray tanks for each bathroom

## Ford® F53 Chassis

362-hp 6.8L Triton® V10 SEFI engine, TorqShift™ 5-speed automatic transmission w/tow/haul, Hydro-Max power brakes, 4-wheel ABS, 175-amp. alternator

7-pin trailer wiring

Trailer Hitch<sup>6</sup> 5,000-lb. drawbar/500-lb. maximum vertical tongue weight

Hydraulic leveling jacks w/3-position controls

Stylized aluminum wheels

## Cab Conveniences

**Cab seats** hinged armrests, fixed lumbar support, and multi-adjustable slide/recline/swivel

**6-way power driver seat**

**3-point seat belts**

**Radio/Rearview Monitor System** 6" LCD color touch screen, remote, iPod®/MP3 input, rear color camera

**Chassis/house battery radio power switch**

**Power steering w/tilt wheel**

**12-volt powerpoint**

**Cruise control**

**Power mirrors w/defrost and sideview cameras**

**Map lights**

**MCD solar/blackout powered front shade**

**Solar shades and privacy curtains for driver and passenger windows**

**Defroster fans**

**Dash workstation**

### OPTIONAL EQUIPMENT

**Passenger seat w/footrest**

**SiriusXM™ receiver** (subscription not included), remote, iPod interface connector

## Interior

**Glide & Dine table/buffet/chairs w/retractable 48" HDTV** (33C)

**48" HDTV** (35G)

**50" HDTV** (36Z)

**Amplified digital HDTV antenna system**

**Electric fireplace** (35G, 36Z)

**LED ceiling lights**

**Satellite system ready** (lounge and bedroom)

**Soft vinyl ceiling**

**MCD solar/blackout roller shades** (on select windows)

**OnePlace® systems center**

**Tinted, dual-glazed, thermo-insulated windows**

**Powered ventilator fan** (bedroom 35G, 36Z)

**Powered ventilator fan** (lounge)

**Powered roof vent** (bath(s))

**Video Selection System**

**Washer/dryer prep** (33C, 35G)

### OPTIONAL EQUIPMENT

**Powered StudioLoft™ ladder, dome LED lights**

**Manual StudioLoft** (33C, 35G)

**Stackable washer/dryer** (33C, 35G)

**Winegard® Mission® automatic satellite TV antenna system**

**Home Theater Sound System** amplifier, DVD player, receiver, speakers, and subwoofer

**Vinyl floor covering throughout** (cab area and slideouts carpeted)



Ford F53 Chassis



## Galley

Corian® solid-surface countertop, decorative backsplash, and sink covers

Microwave/convection oven w/vented range fan

3-burner range top w/cover and storage below

Flip-up countertop extension (33C)

2-door residential refrigerator/freezer w/icemaker (36Z)

4-door refrigerator/freezer w/icemaker (33C, 35G)

### OPTIONAL EQUIPMENT

3-burner range w/cover and oven

Large-capacity 2-door refrigerator/freezer w/icemaker water filter, 2 Group 31 batteries (36Z)

## Bath

Laminate countertop

Flexible showerhead

Textured glass shower door

Skylight

Porcelain toilet w/foot pedal and sprayer

Water pump switch(es)

## Bedroom

Queen bed w/innerspring mattress and storage below (33C, 36Z)

Powered queen bed w/Ideal Rest® Nouveau digital comfort control mattress w/remotes (35G)

Headboard

Bedspread, pillows, and shams

28" HDTV (33C, 35G)

32" HDTV (36Z)

### OPTIONAL EQUIPMENT

Powered king bed w/Ideal Rest Nouveau digital comfort control mattress w/remotes (35G)

King Ideal Rest Nouveau digital comfort control mattress w/remotes (33C, 36Z)

King bed w/innerspring mattress and storage below (33C, 36Z)

Queen Ideal Rest Nouveau digital comfort control mattress w/remotes (33C, 36Z)

## Exterior

Automatic entrance door steps

Porch light (33C, 35G)

Lighted storage compartments

Premium high-gloss fiberglass skin

KeyOne™ lock system

Front mud flaps

Ladder

Powered patio awning w/LED lighting and metal wrap

Powered entrance awning w/LED lighting (36Z)

Lower front protective mask

### OPTIONAL EQUIPMENT

Entertainment Center 32" HDTV w/adjustable bracket, AM/FM stereo, CD/DVD, remote, 2 speakers

## Heating & Cooling System

2 high-efficiency air conditioner heat pumps w/Energy Management System w/ChillGrille™

35,000 BTU low-profile ducted furnace (33C)

40,000 BTU low-profile ducted furnace (35G, 36Z)

## Electrical System

AC/DC electrical distribution system

45-amp. converter/charger (33C, 35G)

50-amp. power cord

5,500-watt Cummins Onan® Marquis Gold™ gas generator

Automatic generator start system (36Z)

Generator/shoreline automatic changeover switch

2 deep-cycle, Group 31 Marine/RV batteries (33C, 35G)

4 deep-cycle, Group 31 Marine/RV batteries (36Z)

Battery disconnect systems (coach and chassis)

PowerLine® Energy Management System

Automatic dual-battery charge control

Auxiliary start circuit

Exterior antenna jack and AC duplex receptacle

1,000-watt inverter (33C, 35G)

2,000-watt inverter/charger (36Z)

Cable TV input

Portable satellite dish hookup

## Plumbing System

Service center color-coded labels, pressurized city water hookup w/diverter valve, drainage valve, 10' sewer hose, QuickPort® service connection hatch, exterior wash station w/lighted pump switch

Permanent-mount LP tank w/gauge

On-demand water pump

TrueLevel™ holding tank monitoring system

Winterization Package water heater bypass valve and siphon tube

Heated holding tank compartment

10-gallon 110-volt/LP water heater w/motoraïd/ auto heater

Gravity water tank fill w/lockable door

Holding tank flushing system (black tank only)

LPG accessory connection (patio area)

## Safety

Child seat tether anchor in forward-facing dinette seat (36Z)

LP, smoke, and carbon monoxide detectors

10 BC fire extinguisher

Ground fault interrupter

High-mount brake lamp

## Warranty<sup>7</sup>

12-month/15,000-mile basic limited warranty<sup>8</sup>

36-month/36,000-mile limited warranty on structure<sup>8</sup>

10-year limited parts-and-labor warranty on roof skin<sup>8</sup>

### FOOTNOTES

- <sup>1</sup> The height of each model is measured to the top of the tallest standard feature and is based on the curb weight of a typically equipped unit. The actual height of your vehicle may vary by several inches depending on chassis or equipment variations. Please check with your dealer for further information.
  - <sup>2</sup> The floorplans feature a wide-body design – over 96" in making your purchase decision, you should be aware that some states restrict access on some or all state roads to 96" in body width. Before making your purchase decision, you should confirm the road usage laws in the states of interest to you.
  - <sup>3</sup> The load capacity of your motorhome is designated by weight, not by volume, so you cannot necessarily use all available space when loading your motorhome.
  - <sup>4</sup> Capacities are based on measurements prior to tank installation. Slight capacity variations can result due to installation applications.
  - <sup>5</sup> Capacities shown are tank manufacturer's listed water capacity (W.C.). Actual filled LP capacity is 80% of listing due to overfilling prevention device on tank.
  - <sup>6</sup> Actual towing capacity is dependent on your particular loading and towing circumstances which includes the GVWR, GAWR, and GCWR as well as adequate trailer brakes. Please refer to the Operator's Manual of your vehicle for further towing information.
  - <sup>7</sup> See separate chassis warranty.
  - <sup>8</sup> See your dealer for complete warranty information.
- NA Not Available
- Not all items available in combination. See dealer for details.
- Winnebago's® continuing program of product improvement makes specifications, equipment, model availability, and prices subject to change without notice. Published content reflects the most current product information at time of printing. Please consult your dealer for individual vehicle features and specifications.





Let us host  
your next

# Adventure

Over 20 Tours  
in 2015



WGOAdventures.com

Connect with Winnebago (Click one of the following)



Like us



Follow us



Watch now



Show your Winnebago love  
with high-quality gifts and wearables.



Apparel | Gifts | Parts | Gear

WinnebagoOutdoor.com

Find your style



**WINNEBAGO**  
OUTDOOR

## WinnebagoInd.com Has All The Answers

Visit [WinnebagoInd.com](http://WinnebagoInd.com) on your computer, smartphone, or tablet for the latest product information and updates.

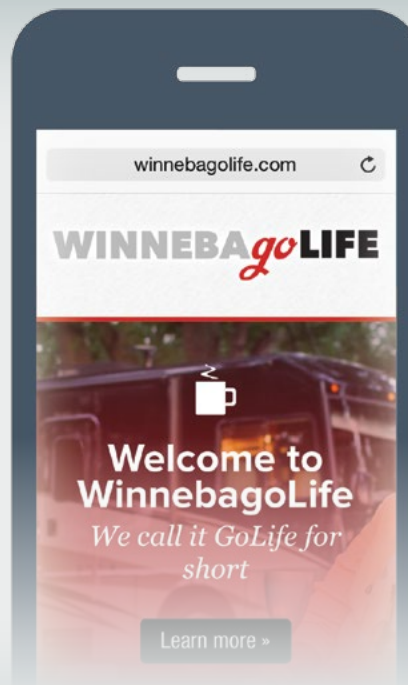
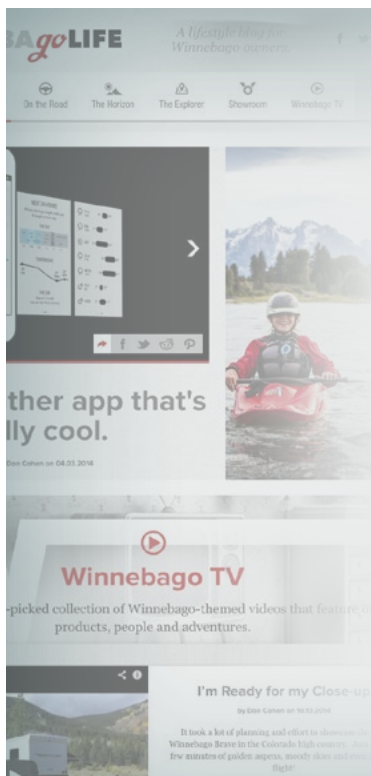

## Welcome to GoLife!

Visit our lifestyle blog  
for motorhome news,  
personal travelogues,  
and community stories.

**WinnebagoLife.com**

**goLIFE**



mywinnebago.com

WINNEBAGO HAS A STORY AND WHAT A STORY IT IS

## Looking Back

Take a Drive Down Memory Lane  
Our favorite history topics in the American heartland of Forest City, Iowa, were here 100 years ago. Preserving and building high quality, eye-catching recreation vehicles. Here's our story between the pages.

1 of 18

## Tell us your story

The story of Winnebago is about the people who love our products and take their wild enthusiasm on the road. Now we want to hear those stories—your stories. Please, do tell. We promise we'll read every word. All story submissions will receive a Crew T-shirt. Additional bonus: If your story is posted to the website, we'll send you a vintage-style Crew T-shirt. Read more about The Crew below.

WRITE YOUR STORY READ ALL ABOUT IT

## Join the Crew

Show Your Pride  
We're looking for a few good men and women on both coasts. We want you everywhere to join The Crew. If you love Winnebago motorhomes and want to show it, you're in! Submit your photos and photos to become part of The Crew.

## See How Far We've Come

MOVE THE SLIDER TO SEE THE EVOLUTION

## Then & Now

The Crew is Back  
In the 1950s, the first Winnebago was built. It was a simple motorhome with its own kitchen and bathroom. Today, it's a full-on motorhome with all the amenities you could want. See the evolution of Winnebago motorhomes.

SEE TRAILER SEE DRIVE

## Add from the Archives

VISIT: MyWinnebagoStory.com

# PREFERRED CARE PROGRAM

We back our motorhomes with best-in-class support both before and after the sale:

- 12-month/15,000-mile basic limited warranty
- 36-month/36,000-mile limited warranty on structure
- 10-year limited parts-and-labor warranty on roof skin
- Complimentary 24-hour roadside assistance program

**TRIPSAVER**  
FAST TRACK PARTS  
**WINNEBAGO**

TripSaver® Fast Track Parts guarantees that in-stock warranty parts ship directly to your dealer within 24 hours

National dealer service network

For more information, visit us  
**WGOService.com**

**WINNEBAGO**  
ROADSIDE ASSISTANCE



From RV to personal insurance, Winnebago RV Insurance can provide all the coverage and services you need to feel at home on the road.

**For more information:**  
**(800) 642-4892**

## CONTACT US

### GENERAL INQUIRIES

Corporate Switchboard  
(641) 585-3535

### CURRENT PRODUCT OWNER AND SERVICE-RELATED INQUIRIES

(800) 537-1885  
or@winnebagoind.com

### NEW VEHICLE SALES INQUIRIES

sales@winnebagoind.com

### FAX

(641) 585-6966

### POSTAL ADDRESS

Winnebago, Inc.  
P.O. Box 152  
Forest City, IA 50436

### STREET ADDRESS

Winnebago, Inc.  
605 West Crystal Lake Road  
Forest City, IA 50436



## Join the Club, Join the Fun

Here's the perfect way to begin your life on the road as the owner of a new Winnebago – by joining the exclusive WIT Club. Start your adventure with other fun-loving WIT Club members from across the country and get the most out of your new Winnebago motorhome.



### Members enjoy:

- Caravans and rallies
- Newsletters
- Local and state group activities
- RV travel benefits

See more at  
**WITClub.com**

©2015 Winnebago  
Seat belts are your most important hookup. Always buckle up.



## Grand National Rally

G'day mates! Explore the outback at this year's "Down Under" Grand National Rally. Each year, thousands of Winnebago owners descend upon the land down under – a.k.a. Forest City, Iowa.

Rally-goers enjoy an unforgettable week reconnecting with friends, taking tours, participating in activities, and more. Hop on down and join the adventure this July!

