



FR3

BY FOREST RIVER

Cross Over Motorhome

25DS

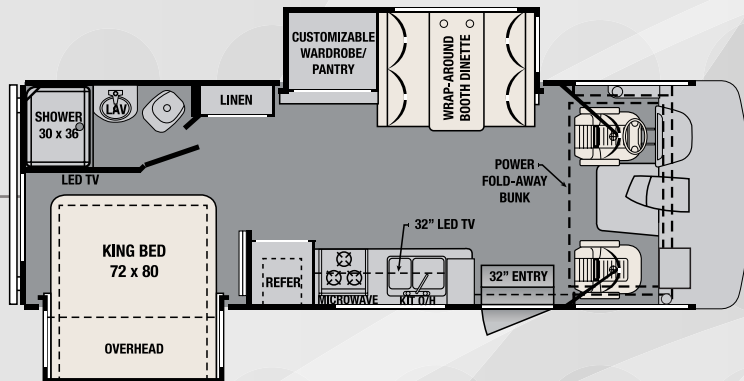

28DS

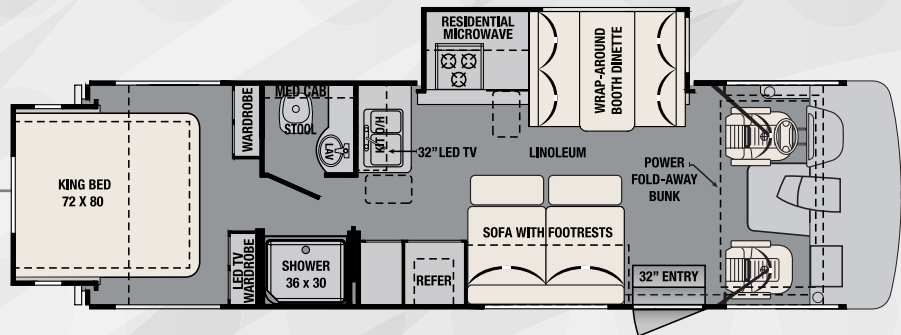

30DS

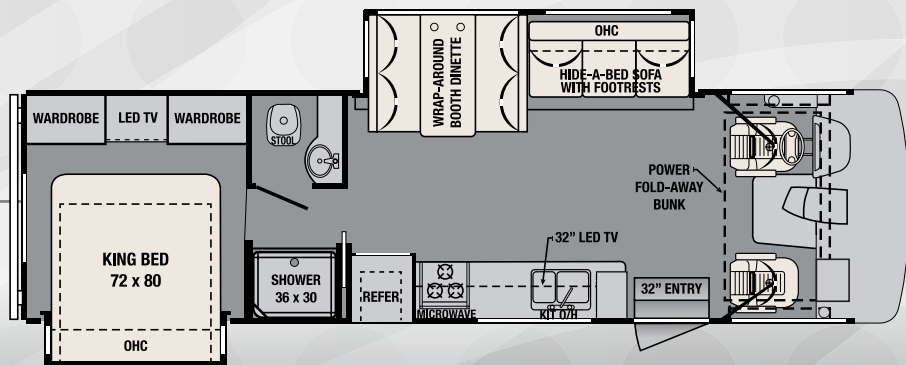

FEATURES & OPTIONS

CONSTRUCTION & EXTERIOR

Flush Floor Construction (no step to get into cockpit area)
 Grey Gel-Coated Sidewalls w/ Graphics
 Automatic Hydraulic Leveling Jacks w/ ABS Cover
 One-Piece Fiberglass Front Cap & Grill
 Headlights w/ LED Rings
 Lower Fog Lights w/ LED Rings
 Colored Back-Up & Side Cameras
 "Super Storage" Rear Pass-Through Cargo Compartment
 Rotocast Storage Boxes w/ Drains
 Radius Alpha SuperFlex Roof (Grey)
 Roof Ladder
 Power Patio Awning w/ LED Light Strip
 Slide Room Topper Awnings
 Rubber Tread Entry Steps
 Power Entry Step
 Rubberized Entry Assist Handle
 Vacuum Bonded Construction (Floor, Sidewalls, Sliderooms & Roof)
 Front Steel Cage
 Outside Entertainment Center w/ 24" LED & Marine Speakers (Bluetooth)

CHASSIS & COCKPIT

Molded ABS Automotive Dash w/ Laptop Console and 110V Outlet
 Power Front Sun Shade (Windshield)
 Ultra Leather Driver/Passenger Seating w/ Double Stitching
 Vinyl Wrapped Low Profile Cockpit Engine Cover
 Pioneer Dash Radio- Bluetooth/AM/FM/CD/DVD w/ LCD Back-Up Monitor, Aux, USB, & Selector Switches (Satellite & Navigation Capable, not provided)
 5,000 lb Tow Hitch w/ 7-Way Plug
 Driver Side Console w/ Cup Holder
 Passenger Side Laptop Station w/ Cup Holder
 Automotive Style Bonded One-Piece Windshield
 Black Exterior Mirrors
 245/70R19.5 G670 Goodyear RV Tires w/ Value Stem Extenders
 Map Lights
 Driver Diamond Plate Floor Mat

INTERIOR

Black Walnut Cabinetry
 Mocha Interior
 Raised Panel Cabinet Door Package
 Entry Assist Handle
 Pioneer Electronics Package w/ Bluetooth CD/DVD & Selector
 Sliding Pocket Door (28DS & 30DS)
 Bedroom Privacy Curtain (25DS only)
 Power Front Fold-Away Overhead Bunk w/ Lockout
 Overhead Bunk Ladder
 32" LED TV (side swing bracket)
 LED FR3 Night Light (25DS & 30DS)
 Radius Interior Ceiling

Wide Wood Plank Trek Flooring Throughout (no carpeted floors)
 18,000 BTU Atwood Quiet Command Ducted Roof A/C w/ Heat Pump
 Brushed Nickel Hardware & Plumbing Fixtures
 Ultra Leather Sofa w/ Dual Footrests (Hide-A-Bed 30DS)
 Ultra Leather Wrap Around Dinette Booth = COMFORT LOUNGE
 Night Shade Window Treatments
 LED Lighting Throughout

GALLEY

Double Door Dometic® Gas/Electric Refrigerator
 3-Burner Cooktop w/ Oven
 Microwave Oven
 Large Double Bowl Stainless Steel Sink & Fixture
 Laminate Countertops
 Large Coat/Broom/Storage/Pantry Closet
 Kitchen Drawers w/ Heavy Duty Full Extension Drawer Guides
 Trash Can Storage Area
 Pullout Countertop Extension & Countop Drawer (28DS Only)

BEDROOM & BATHROOM

72" X 80" Residential King Bed
 Bedroom Wardrobe
 Toilet w/ Foot Flush
 Stainless Steel Lavatory Sink & Fixture
 Brushed Nickel Framed / Sliding Glass Shower Door
 Piano Hinged Bathroom Door
 Heavy Duty Full Extension Drawer Guides
 24" LED TV (Bedroom)

SAFETY & CONVENIENCE

Entry Door with Deadbolt Lock
 Forest River Command Center
 Smoke, LPG & Carbon Monoxide Detectors
 Fire Extinguisher
 1 Year Coach-Net Road Side Assistance w/ New Purchase

ELECTRICAL & PLUMBING

4.0 kW Onan® Gas Generator
 2 Deep Cycle House Batteries w/ ABS Cover
 Battery Disconnect Switch
 Emergency Start Switch
 Black Tank Flush
 Outside Shower
 30 amp Power Cord w/ Storage Compartment
 6 Gallon Gas/Electric Water Heater
 Arctic Pack System (Heated Holding Tanks)
 35,000 BTU Furnace
 KING JACK® Power HDTV Antenna w/ Surelock Signal Meter
 12V Prewire for Power Roof Vents

OPTIONS

EVERYTHING IS STANDARD = NO OPTIONS

SPECIFICATIONS

	25DS	28DS	30DS
Wheelbase	158"	190"	190"
GVWR (lbs.)	16,000	18,000	18,000
GCWR (lbs.)	23,000	23,000	23,000
Fuel Capacity (gal.)	80	80	80
Exterior Length	26' 10"	29' 10"	31' 10"
Exterior Height	12' 2"	12' 2"	12' 2"
Exterior Width	99.5"	99.5"	99.5"
Fresh Water (gal.)	57	57	57
Grey Water (gal.)	41	41	41
Black Water (gal.)	41	41	41
Awning Size	12'	16'	16'



Learn More
 Scan this barcode using
 a QR Reader on your
 smart phone to learn
 more about Forest River.



A Berkshire Hathaway company.

For more information, call **574.532.1240**

All specifications contained herein are based on the latest product information at time of printing. Forest River reserves the right to make changes in colors, materials, equipment and specifications at any time without notice and assumes no responsibility for any errors in this brochure. The pictures in this brochure may show props and optional equipment. 04/15

©Copyright 2015 Forest River Inc – All Rights Reserved.